

SHOPS @ SEDONA LAKES

1875 CR 101
MANVEL, TEXAS 77578

PROJECT NUMBER 18-38

ARCHITECT: JOSEPH M. FOSTER & ASSOCS.
5503 VALERIE
HOUSTON, TEXAS 77081
(713) 432-1428
email jmfassoc@comcast.net

STRUCTURAL ENGINEER: BEC-LIN ENGINEERING
10401 WESTOFFICE DR.
HOUSTON, TEXAS 77042
(281) 664-8441
(281) 664-8457 FAX

CIVIL ENGINEER: ALJ LINDSEY, L.L.C.
5627 FM 1960 WEST, SUITE 314
HOUSTON, TEXAS 77069
(281) 301-5955

MEP ENGINEER: SALAS O'BRIEN
10930 W. SAM HOUSTON PWY. N., SUITE 900
HOUSTON, TEXAS 77064
(281) 664-1900

LANDSCAPE ARCHITECT: CMB LANDSCAPE ARCH.
18135 FM 362
NAVASOTA, TEXAS 77868
(832) 428-1209

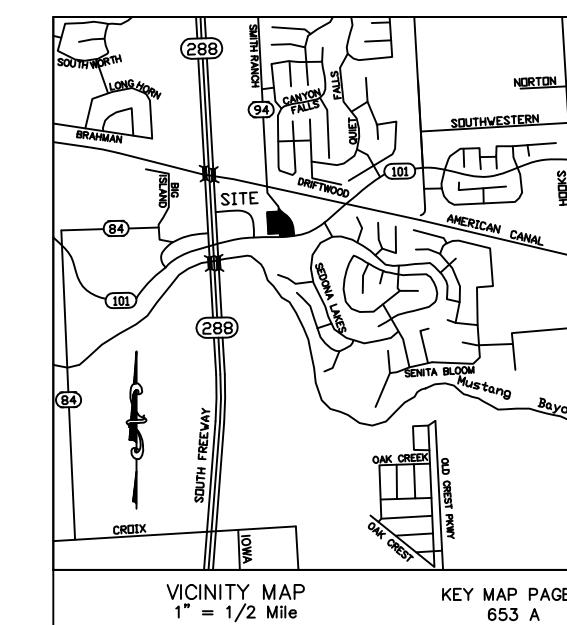

KEY MAP NO. 653-A

DRAWINGS:

COVER SHEET
CIVIL: (UNDER SEPARATE ISSUE)

PG. NO.	ARCHITECTURAL:
1	COVER
2	A-0.0 ARCHITECTURAL SITE PLAN
3	A-0.1 SITE DETAILS
4	A-0.2 PROJECT ABBREVIATIONS, SYMBOLS AND GENERAL NOTES
5	A-1.1 FLOOR PLAN & DETAILS
6	A-1.2 EXTERIOR ELEVATIONS
7	A-1.3 ROOF PLAN & DETS.
8	A-2.1 BUILDING CROSS-SECTION & DETAILS
9	A-2.2 WALL SECTIONS
10	A-2.3 WALL SECTIONS
11	A-2.4 SECTIONS & DETS.
12	A-3.1 DR. & RM. FIN. SCHEDS., DR. TYPES, NOTES & DETS.

PG. NO.	STRUCTURAL:
13	S1.0 FOUNDATION PLAN
14	S2.0 FOUNDATION DETAILS
15	S2.1 FOUNDATION DETAILS
16	S3.0 ROOF FRAMING PLAN
17	S3.1 FRAMING DETAILS
18	S3.2 FRAMING DETAILS
19	S4.0 GENERAL NOTES

PG. NO.	MECH., ELECTRICAL & PLUMBING:
20	EP1.0 ELEC. PLUMB. SITE PLAN
21	EP1.1 ELEC. PHOTOMETRIC SITE PLAN
22	E1.0 ELEC. FLOOR PLAN
23	E2.0 ELEC. SCHED., NOTES & ONE-LINE-DIAGRAM
24	E3.0 ELEC. SPEC., DETS., NOTES & LEGENDS
25	P1.0 PLUMB. FLOOR PLAN
26	P2.0 PLUMB. SPEC., NOTES & LEGENDS
27	P3.0 PLUMB. DETS.

PG. NO.	LANDSCAPE
28	L-1.0 PLANTING PLAN
29	L-2.0 IRRIGATION PLAN
30	L-2.1 LANDSCAPE DETS.

PG. NO.	FIRE
31	F-1 FIRE ACCESS SITE PLAN

ISSUES & REVISIONS:

03.26.19	85% COMPLETION
04.09.19	ARC SUBMITTAL
05.20.19	ARC & PERMIT SUBMITTAL
-	-
-	-